



**brav**ia

THE DESIGNER'S CHOICE

# MARQUEE CEILING PANELS

Elevating Elegance  
in Every Space

[www.braviainterior.com](http://www.braviainterior.com)



# About Us

**Bravia was incorporated in 2006.**

Bravia offers products of global standards to consumers in India. The culture of innovation and renovation within the company and research and development gives it a distinct advantage in these efforts. It helps the Company to create value that can be sustained over the long term by offering consumers a wide variety of high quality, products at affordable prices.

Crafted Nature:  
Transforming Your  
Space with Real Wood  
Feels Soffit Panels

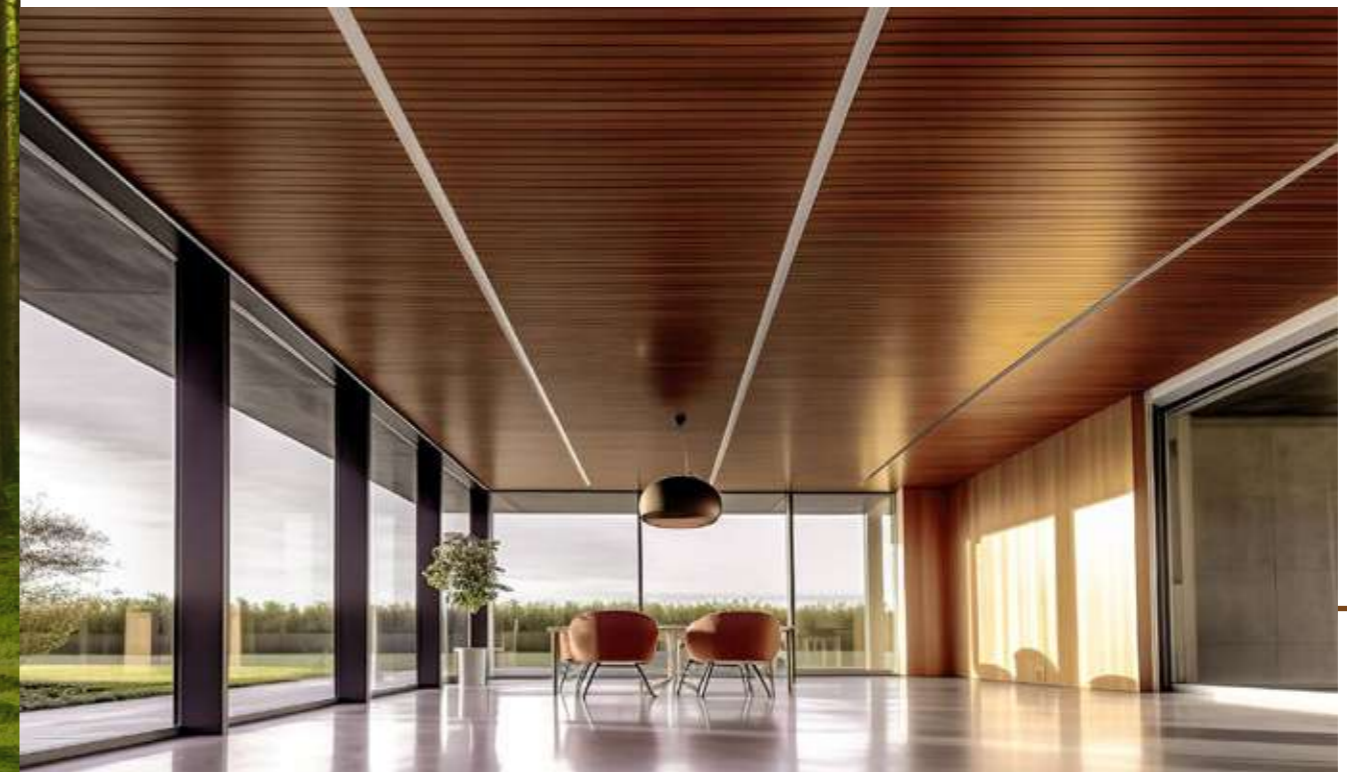



# Marquee Ceiling Panel Benefits:



FIRE RETARDANT



EASY TO INSTALL



WATER PROOF



MAINTENANCE FREE



ANTI - BACTERIAL



LIGHT WEIGHT



TERMITE & RUST PROOF



NO VOC EMISSION



SEAMLESS POST  
INSTALLATION



REAL WOOD FEEL



# Product Specifications

## Cabbana Series:





## Slate Series:



MAHOGNAY SL05



DARK OAK SL02



LIGHT OAK SL01



WALNUT SL03

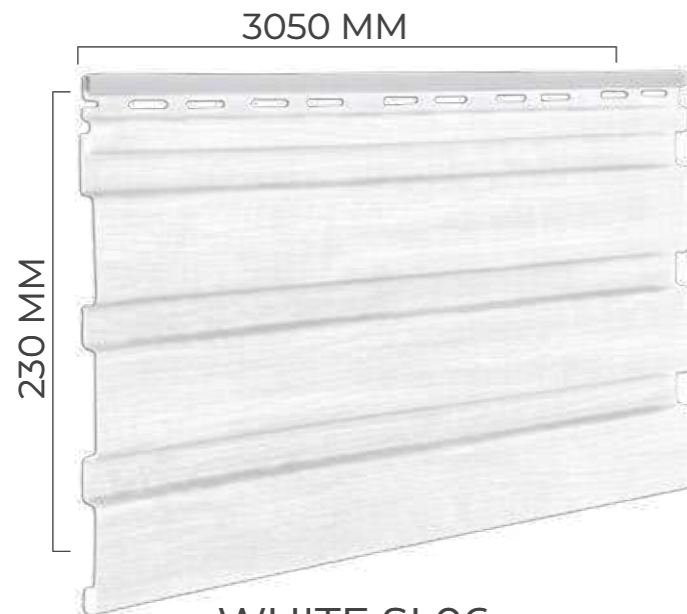

WHITE SL06



TEAK SL04

# Installation Details

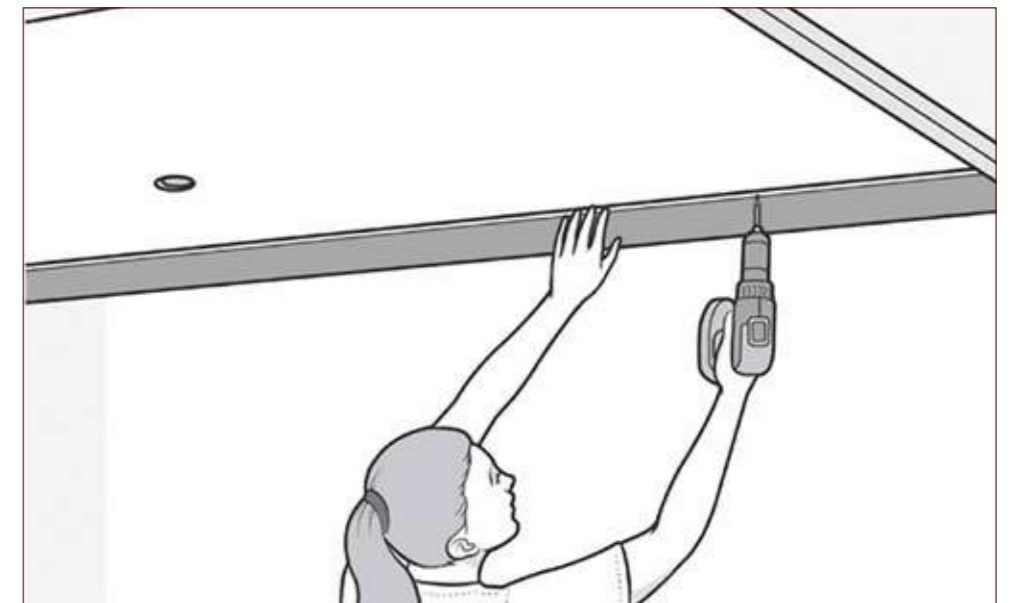

## **DIRECTLY SCREW TO WALL/CEILING**

Revamp your space effortlessly with Marquee Ceiling Panels! Say goodbye to plywood and cumbersome adhesives. These panels conveniently screw directly onto walls, cutting down on both time and expenses. With seamless interlocking, transforming your space has never been simpler!

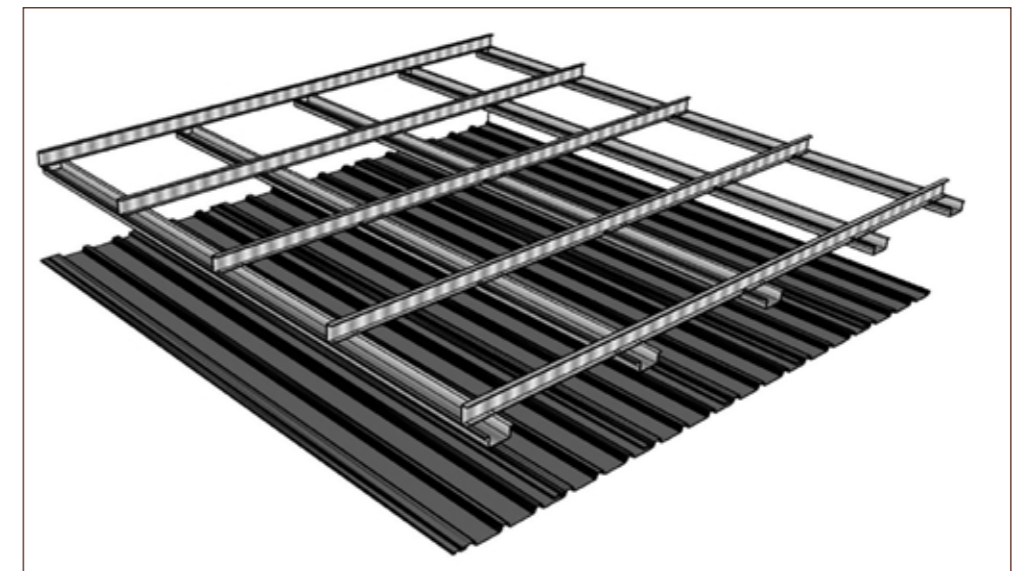

## **GI/ALUMINIUM FRAMING**

GI or Aluminum framing is perfect for anchoring Marquee Panels. It can be securely screwed on to this sturdy framework.





### From **Inside to Outside** :

The use of the same panels on the ceiling inside the building and on the adjacent terrace will result in a uniform, coherent space.

### Use **Of Lighting**:



The panels can be fitted with numerous lighting points. Properly selected lighting improves the atmosphere of the place making it unique while the surroundings of the house gain in aesthetics.

### **Unusual Surfaces:**

The Infratop system can be used on unusual surfaces. The panels and finishes are flexible, which allows, for example, to finish arches and curved walls.



### **Design Possibilities:**



The product offers many design possibilities. It can be installed horizontally, vertically or diagonally.







Ideal for **Outdoor Ceilings, Indoor Ceilings** and **Interior Applications.**

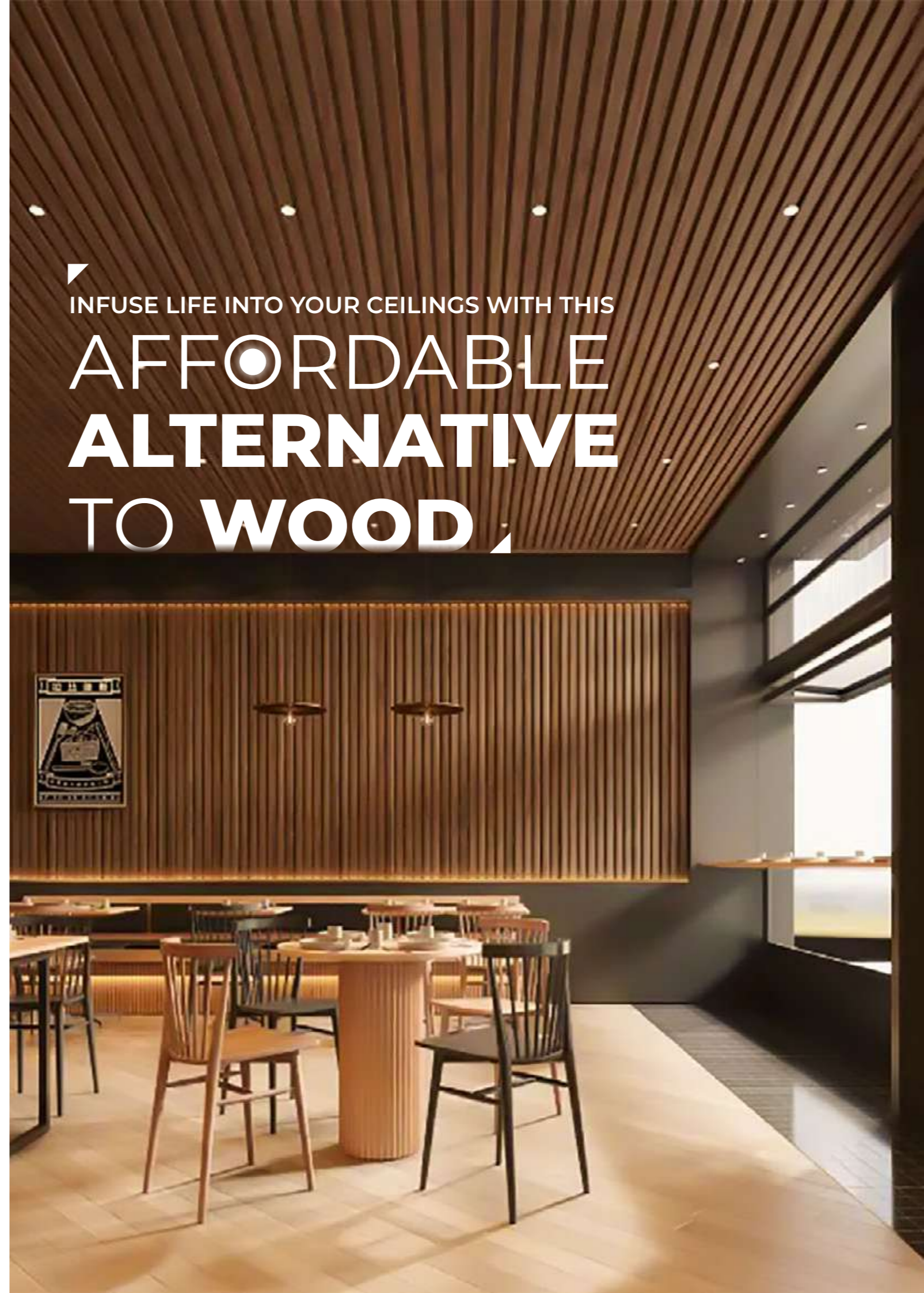

INFUSE LIFE INTO YOUR CEILINGS WITH THIS  
**AFFORDABLE  
ALTERNATIVE  
TO WOOD**



# Environmental Advantages



## RECYCLING

We use up to 80% recycled materials in production, depending on the product.



## DURABILITY

Our products are highly durable, with lifespans of 10 to 50 years for many items.



## MAINTENANCE

Maintenance-free lifespan eliminates the need for additional chemicals like paints or preservatives.



## INSULATION

Soffits provide roof ventilation and moisture protection.



## SAFETY

Harmful substances such as lead and tin are not used in the production process.



## HEALTH

Our products are safe, free from harmful substances, and emit no volatile organic compounds.



## CARBON FOOTPRINT

Cuts carbon footprint by up to 40% versus synthetic polymer products.



# Materials Comparison

	Marquee Ceiling Panels	Wooden Ceilings
<b>Product Price</b>	Affordable.	More expensive.
<b>Installation Cost</b>		
<b>Installation</b>		
<b>Product Weight</b>	Light panels facilitate transport and installation. No load on the building structure.	Material is much heavier, and more difficult to handle.
<b>Installation Time</b>	Quick and easy installation. Ready to use panels, no additional work required after installation.	Extended and Longer time for Installation. Need polishing.
<b>Installation Method</b>	Built-in CLICK lock and factory-made screw holes facilitate faster installation. No dust during installation.	No interlock and mounting holes. Lot of dust during installation.
<b>To uninstall and repair</b>	Easy to uninstall, just unscrew to remove the panels and refix again. Panels can be removed and reused at other place.	Very difficult to uninstall.
<b>Features</b>		
<b>Appearance and Texture</b>	Pattern reflects the natural texture of the wood, which gives wood alike feel and natural effect. Textures repeat after every 100 running meters.	Requires impregnation to achieve required wood colour and also to repeat impregnation on regular intervals to maintain the colour and the finish.



# Products

## **BRAVIA LAM**

1MM LAMINATES

## **ACRYLITE**

ANTI-SCRATCH ACRYLIC LAMINATES

## **ZENITH**

PS WALL PANEL

## **MARQUEE**

PVC CEILING PANEL

## **PRO MOULD**

PAINTABLE PVC MOULDING

## **MARVEL**

DESIGNER MIRROR ACRYLIC

## **SHEER**

DESIGNER WALL PANELS

## **ARTISAN COLLECTION**

NATURAL HANDICRAFT

# bravia

THE DESIGNER'S CHOICE



: 1305, 13<sup>th</sup> Floor, Lotus Trade Centre, New Link Road, Andheri (W), Mumbai



: +91 93209 51220



: [www.braviainterior.com](http://www.braviainterior.com)



: [info@braviainterior.com](mailto:info@braviainterior.com)



SCAN QR CODE

Follow us on:

